

More than just precise – slim, light and dependable!



# HandyStep®<sup>S</sup>

## Solutions for Science

F I R S T C L A S S · B R A N D

The **HandyStep®<sup>S</sup>** repetitive pipette fits the hand like a glove, offers highly dependable performance and is simple to operate.

■ **Truly stress-free!**

Well-balanced weight distribution, ergonomic control element layout

■ **Always dependable!**

Robust construction, inspired design, and innovative polymers

■ **Always ready to use!**

No battery-dependent display, no battery change!  
Integrated volume table

■ **Highly versatile!**

10 PD-Tip sizes, 59 different volumes. Accepts third-party dispenser tips!

■ **Contact-free!**

Eject tips with the press of a button – never any tip contact!





**HandyStep® S – the repetitive pipette for any occasion!**

Ideal for routine or research applications in diagnostics, molecular biology, environmental analysis, and many more.

HandyStep® S and PD-Tips work on the direct displacement principle. This offers the highest-precision dispensing of liquid media with high viscosity, high density, or high vapor pressure. Direct displacement permits contamination-free operation, since no aerosols are formed.

**More data and facts:**

- increased chemical resistance through innovative plastic materials
- easy tip mounting – PD-Tip is now simply inserted from below
- dispensed volume range from 2 µl to 5 ml
- up to 49 dispensing steps
- weighs only 108 g
- suitable for use with BRAND PD-Tips, Encode™ tips, Repet tips, Combitips®, Combitips® plus and other compatible dispenser tips
- CE-**IVD**-compliant

# HandyStep® S Solutions for Science



Repetitive dispensing



Dispenser tip ejection

**Safe!** At the push of a button! Ergonomic eject button for contact-free, safe ejection of contaminated dispenser tips.

**Versatile!** In addition to PD-Tips from BRAND, compatible dispenser tips from other manufacturers can also be used.

## At a glance ...

**Precise!** Clear, large stroke selection indicator – for fast, simple checking.

**Perfect!** Optimally positioned dispensing lever, easy on the thumb.

**Straightforward!** Double-sided volume table on the back side for quick adjustments! (see below)

**Rapid!** One-handed volume adjustment for right- and left-handed operators – even with gloves!

**Comfortable!** Ergonomic finger loop to keep the hand relaxed, important when conducting long series!

**Simplified!** Just one lever for locking the piston and filling the PD-Tip!

Rack mount for HandyStep® S

The rack mount also fits the Transferpette® S bench-top rack.

**Fast volume selection**

The double-sided volume table on the back side shows all the necessary stroke setting information at a glance.



Volume table HandyStep® S with PD-Tips

| Setting | Tip size (ml) |     |     |       |     |     |      |      |      |      | Steps |
|---------|---------------|-----|-----|-------|-----|-----|------|------|------|------|-------|
|         | 0.1           | 0.5 | 1   | 1.25  | 2.5 | 5   | 10   | 12.5 | 25   | 50   |       |
| 1       | 2             | 10  | 20  | 25    | 50  | 100 | 200  | 250  | 500  | 1000 | 49    |
| 1.5     | 3             | 15  | 30  | 37.5  | 75  | 150 | 300  | 375  | 750  | 1500 | 32    |
| 2       | 4             | 20  | 40  | 50    | 100 | 200 | 400  | 500  | 1000 | 2000 | 24    |
| 2.5     | 5             | 25  | 50  | 62.5  | 125 | 250 | 500  | 625  | 1250 | 2500 | 19    |
| 3       | 6             | 30  | 60  | 75    | 150 | 300 | 600  | 750  | 1500 | 3000 | 15    |
| 3.5     | 7             | 35  | 70  | 87.5  | 175 | 350 | 700  | 875  | 1750 | 3500 | 13    |
| 4       | 8             | 40  | 80  | 100   | 200 | 400 | 800  | 1000 | 2000 | 4000 | 11    |
| 4.5     | 9             | 45  | 90  | 112.5 | 225 | 450 | 900  | 1125 | 2250 | 4500 | 10    |
| 5       | 10            | 50  | 100 | 125   | 250 | 500 | 1000 | 1250 | 2500 | 5000 | 9     |

Volume (µl)



# Technical Data



## HandyStep® S

DE-M marking, with serial number, performance certificate, operating manual, shelf/rack mount, 3 PD-Tips: 0.1 ml, 1 ml and 10 ml. Pack of 1.

Cat. No. 7051 10

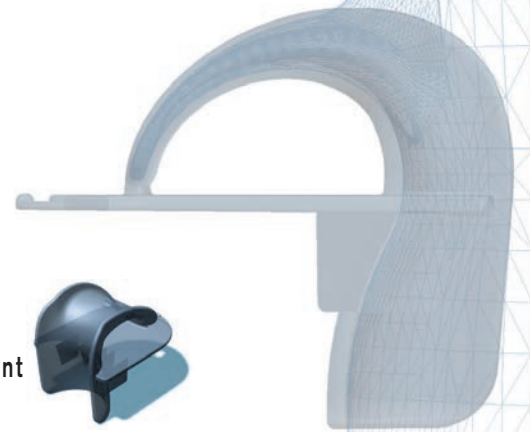

## Shelf / Rack mount

for HandyStep® S.  
Pack of 1.

Cat. No. 7051 30

## PD-Tips (Precision Dispenser Tips) from BRAND

| Capacity ml | Pack of  | non sterile Cat. No. | sterile** Cat. No. | BIO-CERT® Cat. No. |
|-------------|----------|----------------------|--------------------|--------------------|
| 0.1         | 100      | 7024 02              | 7024 04            | 7026 83            |
| 0.5         | 100      | 7023 70              | 7023 84            | 7026 84            |
| 1           | 100      | 7024 06              | 7024 36            | 7026 85            |
| 1.25        | 100      | 7023 72              | 7023 86            | 7026 86            |
| 2.5         | 100      | 7023 74              | 7023 88            | 7026 88            |
| 5           | 100      | 7023 76              | 7023 90            | 7026 90            |
| 10          | 100      | 7024 07              | 7024 38            | 7026 91            |
| 12.5        | 100      | 7023 78              | 7023 92            | 7026 92            |
| 25*         | 50/25*** | 7023 80              | 7023 94            | 7026 94            |
| 50*         | 25       | 7023 82              | 7023 96            | 7026 96            |



PD-Tips BIO-CERT® are sterile, free of endotoxin, DNA, RNase and ATP.

\* incl. 1 adapter, \*\* sterile/free of endotoxin – single wrapped, \*\*\* PD-Tips 25 ml: non sterile pack of 50 / sterile pack of 25

## Accuracy Table (PD-Tips from BRAND, 20 °C 'Ex', DE-M marking)

| PD-Tip size ml | Volume range µl | A* ≤ ± %                                    |        |         | CV* ≤ %                                     |        |         |
|----------------|-----------------|---------------------------------------------|--------|---------|---------------------------------------------|--------|---------|
|                |                 | Stroke setting ± % of nominal volume 1 ± 2% | 3 ± 6% | 5 ± 10% | Stroke setting ± % of nominal volume 1 ± 2% | 3 ± 6% | 5 ± 10% |
| 0.1            | 2 - 10          | 4.0                                         | 2.4    | 1.6     | 6.0                                         | 3.0    | 2.0     |
| 0.5            | 10 - 50         | 2.5                                         | 1.5    | 1.0     | 2.5                                         | 1.5    | 1.0     |
| 1              | 20 - 100        | 2.5                                         | 1.5    | 1.0     | 2.0                                         | 1.2    | 0.8     |
| 1.25           | 25 - 125        | 2.5                                         | 1.4    | 0.9     | 2.0                                         | 1.1    | 0.7     |
| 2.5            | 50 - 250        | 1.8                                         | 1.1    | 0.7     | 1.5                                         | 0.9    | 0.6     |
| 5              | 100 - 500       | 1.8                                         | 1.1    | 0.7     | 1.5                                         | 0.9    | 0.7     |
| 10             | 200 - 1000      | 1.8                                         | 1.1    | 0.7     | 2.0                                         | 1.2    | 0.8     |
| 12.5           | 250 - 1250      | 1.8                                         | 1.1    | 0.8     | 3.2                                         | 2.0    | 1.4     |
| 25             | 500 - 2500      | 1.5                                         | 0.9    | 0.6     | 3.0                                         | 1.5    | 1.0     |
| 50             | 1000 - 5000     | 1.5                                         | 0.8    | 0.5     | 5.0                                         | 1.8    | 1.2     |

A\* = Accuracy, CV\* = Coefficient of variation

### The nominal volume is the maximum volume printed on the PD-Tip.

Error limits refer to the partial volume set relative to the PD-Tip size, obtained at equal temperature (20 °C) of instrument, tip, ambience and dist. H<sub>2</sub>O, and with smooth, steady operation. The testing is according to DIN EN ISO 8655-5.

HandyStep® and BRAND® are trademarks of BRAND GMBH + CO KG, Germany. Other reproduced brands are the property of the respective owner.

Our technical literature is intended to inform and advise our customers. However, the validity of general empirical values, and of results obtained under test conditions, for specific applications depends on many factors beyond our control. Please appreciate, therefore, that no claims can be derived from our advice. The user is responsible for checking the appropriateness of the product for any particular application.

Subject to technical modification without notice. Errors excepted.

BRAND GMBH + CO KG · P.O. Box 11 55 · 97861 Wertheim · Germany  
Tel.: +49 9342 808-0 · Fax: +49 9342 808-98000 · E-Mail: info@brand.de · Internet: www.brand.de

